

WIRELESS HaLow WIFI KIT



Introducing our HaLow 8MP WiFi security solution with 4K resolution, featuring new HaLow wifi technology that transmits signal up to 400 meters. This state-of-the-art surveillance system combines exceptional image clarity and detail with intelligent control capabilities. You'll enjoy images of exceptional clarity in 4K resolution. Each camera can be used with a battery or power block. It detects and analyzes events, providing precise notifications for rapid response. With easy P2P QR code configuration, instant notifications and a host of additional features, this camera kit offers complete surveillance solutions for your peace of mind. This camera kit offers a versatile solution that can be used on a construction site, or in a residential environment.



8MP 4K RESOLUTION



DETERRENCE & SIREN



400 METER HALOW WIFI



INSTANT NOTIFICATIONS

Onvif®



TWO-WAY COMMUNICATION



P2P CLOUD



BATTERY BACKUP

NETWORK VIDEO RECORDER

VIDEO	
RESOLUTION	3840*2160 (8MP)
INPUTS	8CH (WiFi 802.11ah)
LIVE	
RESOLUTION	3840*2160 (8MP)
FRAME	4K UHD@15fps(Auto fps, Adaptive bitrate)
MULTI SCREEN DISPLAY	1/ 4/ 9
RECORDING	
COMPRESSION	Video : H.265, Audio: G.726
FRAME RATE	4K UHD@15fps(Auto fps, Adaptive bitrate)
EVENT TYPE	Motion/Human Detection, MD + PIR (Sensitivity Level 1-6), HDD (Full, Failure)
HDD FULL EVENT	Email, Push notification to Mobile APP
NETWORK	
TRANSMISSION BANDWIDTH	Max Up to 32Mbps
PROTOCOL SUPPORT	TCP/IP, UDP/IP, RTP(UDP), RTP(TCP), RTSP, NTP, HTTP, DHCP, SMTP, DNS, DDNS
LED	Power : BLUE / Record : RED
STORAGE	
INTERNAL SD CARD SLOT	Yes
INTERNAL HDD	HDD*1 (Ma x 6TB) (Not Included)
USB (BACK-UP)	Yes
FILE FORMAT (BACK-UP)	AVI, RF, MP4
INTERFACE	
HDMI	HDMI*1 (1280*1024, 1280*720, 1920*1080, 2560*1440, 3840*2160) EDID (monitor resolution auto detection)
ETHERNET	1 RJ45 10/100 Base-T
USB	USB2.0 * 2 (for mouse and backup/upgrade)
APPLICATION SUPPORT	USB Mouse
GENERAL	
OSD LANGUAGE	Multiple / Default English
DESIGN	White / Metal
DIMENSION (WxDxH)	300* 227mm * 53mm
INPUT VOLTAGE/CURRENT	DC12V/2A
POWER CONSUMPTION	TBD
OPERATING TEMPERATURE/HUMIDITY	Temperature : 0°C~+40°C (32°F ~ 104°F) Humidity : 20% ~ 85%RH

WIFI CAMERA

DESIGN	
SENSOR	8MP
EFFECTIVE PIXELS	3840*2160 (16:9) 1/2.7"
RESOLUTION	3840*2160 (8MP)
MIN. ILLUMINATION	0Lux (IR LED ON)
WIFI TRANSMISSION DISTANCE	Max 700M (Empty No interference distance)
PIR	YES
FOCAL LENGTH	2.8mm
F NO.	F1.6
ANGULAR FIELD OF VIEW	H:111° V:59° D:134°
SHUTTER MODE	Auto
GAIN CONTROL	Auto
WHITE BALANCE	Auto
WIDE DYNAMIC RANGE	N/A
DIGITAL NOISE REDUCTION	3DNR
DAY & NIGHT	TRUE D/N, Auto
NIGHT DISTANCE	Up to 15M
WHITE LED DISTANCE	Up to 15M
PIR DISTANCE	120°, 35ft(10M)
INGRESS PROTECTION	IP66
INPUT VOLTAGE	DC5V
POWER CONSUMPTION	TBD
MECHANICAL DESIGN	White / Metal
MIC	YES
SPEAKER	YES
SD CARD SLOT	Internal SD card slot
OPERATING TEMPERATURE / HUMIDITY	-20°C ~ +50°C / Less than 90% RH Startup : -10°C ~ +50°C

ACCESSORIES

BATTERY

BAT-WLFNC



CABLE

PWR-WL5V-2A



15
FEET

5V-2
AMP

OPTION
✓ WIRE PROTECTOR

SOLAR PANEL

SOL-12V



LINE OF ART

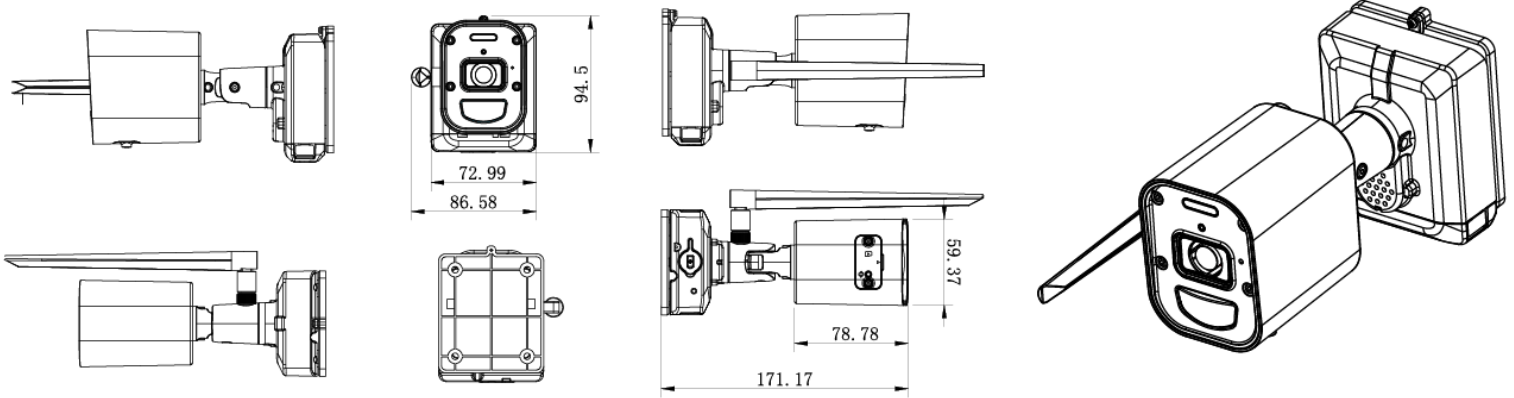

2023 Global Surveillance Development, GSD Group and GSD are registered trademarks of Global Surveillance Development Group, Inc. in Canada and / or other countries.
We reserve the right to change the design and specifications of the product Without notice and without incurring any obligation.